

5 March 2019

To: The Leader and Deputy Leader; Councillors Howard Bairstow; David Fenn; David Fish; James Fredrickson; John Gardner; Sarah Greenall; Arthur Johnson; Kuldip Singh Kang; Margo Payne; Martha Vickers.

Substitutes: Councillors Jeff Beck; Lynne Doherty; Jo Day; Mike Johnston; Elizabeth O'Keeffe; Anthony Pick.

Also: All Members of the Council for information.

Dear Councillor,

You are required to attend a meeting of the Community Services Committee to be held in the Council Chamber, Town Hall, Market Place, Newbury, on **Monday 11 March 2019 at 7.30pm**. This meeting is open to the Press and Public.

Yours sincerely,

Hugh Peacocke
Chief Executive Officer

AGENDA

1. Apologies for Absence

Community Services Manager

2. Declarations of Interest and Dispensations

Chairperson

To receive any declarations of interest relating to business to be conducted in this meeting and confirmation of any relevant dispensations.

3. Minutes (Appendix 1)

Chairperson

To approve the minutes of a meeting of the Community Services Committee held on Monday 10 December 2018, already circulated and as attached at Appendix 1.

4. Questions and Petitions from Members of the Public

Chairperson

5. Members' Questions and Petitions

Chairperson

Town Hall, Market Place, Newbury, RG14 5AA

 (01635) 35486

 (01635) 40484

 @NewburyTC

 towncouncil@newbury.gov.uk

 www.newbury.gov.uk

 NewburyTC

Newbury Town Council is committed to continuing to make Newbury a better place to live, work and visit.

6. Newbury in Bloom (Appendix 2a & 2b)

Chairperson

To note the minutes of the Newbury in Bloom Working Group of 20 December 2018 24 January and 21 February 2019 as attached at Appendices 2a & 2b.

7. Allotment Councillor Visits 2019

Chairperson

To consider the proposal to defer the Annual Councillor visit & prize giving to Newbury Town Council Allotments for 2019 in view of the work & input needed for the Britain in Bloom application & subsequent visit by the Newbury in Bloom Judges in July 2019.

8. Victoria Park Family Day 2019

Chairperson

To consider the proposal to hold the 2019 Annual Victoria Park Family Day on Sunday 16th June 2019.

9. Market Working Party (Appendix 3)

Chairperson

To note the minutes of the Market Working Party held on 28 January 2019.

10. Community Services Managers Report (Appendix 4)

Community Services Manager

To receive a report from the Community Services Manager

11. City Recreation Ground Consultation (Appendix 5)

Chairperson

To receive a report on the outcomes of the public consultation in respect of City Recreation Ground

12. Dickens Walk Playground Equipment (Appendix 6)

Chairperson

12.1 To consider a proposal to allocate funding from S106 monies to allow the replacement of play equipment at Dickens Walk Playground.

12.2 To resolve to allocate S106 funds of £2,300 to install the new play equipment at Dickens Walk

13. Defibrillator at the Town Hall (Appendix 7)

Chairperson

To consider a proposal to provide a defibrillator in Newbury Town Hall.

14. Victoria Park Ice Rink (Appendix 8)

Chairperson

To receive a report on the viability of an ice-rink at the pond in Victoria Park

15. Forward Work Programme for Community Services Committee meetings (Appendix 9)

Chairperson

To note and agree any other items that Members resolve to add to the Forward Work Programme

16. Exclusion of the Press and Public

Chairperson

To move: That under Section 1, Paragraph 2 of The Public Bodies (Admission to Meetings) Act 1960 the press and public be excluded from the meeting for the following item of business because publicity would be prejudicial to the public interest by reason of the confidential financial business to be transacted.

17. New Café and sports changing rooms for Victoria Park (Appendix 10)

Chairperson

To receive an update on proposals for the construction of a new café and sports changing rooms for Victoria Park

If you would like a paper copy or large print copy of this agenda please request this from the Reception Desk at the Town Hall.

**MINUTES OF A MEETING OF THE COMMUNITY SERVICES COMMITTEE HELD IN THE
COUNCIL CHAMBER, TOWN HALL, MARKET PLACE, NEWBURY
ON MONDAY 10 DECEMBER 2018 AT 7.30PM**

PRESENT

Councillors Howard Bairstow; Jeff Beck; (named substitute); Adrian Edwards; David Fenn; David Fish; James Fredrickson; John Gardner; Sarah Greenall (Chairperson); Arthur Johnson; Margo Payne; Kuldip Singh Kang; Martha Vickers.

In Attendance

Hugh Peacocke, Chief Executive Officer
Caroline Edmunds, Community Services Officer

38. APOLOGIES FOR ABSENCE

Councillor: Miles Evans

39. DECLARATIONS OF INTEREST AND DISPENSATIONS

The Chief Executive Officer declared that Councillors Adrian Edwards, Howard Bairstow, James Fredrickson and Jeff Beck are also Members of West Berkshire Council, which is declared as a general interest on their behalf and a dispensation is in place to allow them to partake in discussions relating to West Berkshire Council business.

40. MINUTES

PROPOSED: Councillor Margo Payne
SECONDED: Councillor Howard Bairstow

RESOLVED: That the minutes of the meeting of the Community Services Committee held on 24 September 2018, be approved and signed by the Chairperson.

41. QUESTIONS AND PETITIONS FROM MEMBERS OF THE PUBLIC

There were none.

42. MEMBERS' QUESTIONS AND PETITIONS**Question from Cllr Martha Vickers:**

“In the light of concerns expressed about the lack of amenities for boaters visiting our beautiful canal how can this Council work with the Canal and Rivers Trust to improve this situation?”

Response from Chairperson:

“The Council recognises the canal as one of Newbury’s greatest assets. It is of tremendous amenity, leisure and environmental value and one of our key tourism attractions. The canal bridge and various other locations close to town present some of our most attractive vistas.

Recognising this, we have already started work on strengthening the provisions in the Town Design statement aimed at further protecting and enhancing the canal and its settings and environs. The leader of the Council, Councillor Adrian Edwards and the Chief Executive is leading this work. A working group will be meeting in the New Year to progress this work and

a representative from The Kennet and Avon Canal Trust and from the Canal and Rivers Trust will be invited to join us for these meetings.

At the last meeting of the Planning and Highways Committee, this Council responded to the District Council's Local Plan review consultation and among our replies, we advised that the local plan specific policy to develop the river and the Canal as a leisure and tourism centre/facility."

Councillor Vickers asked that the Working Group considers facilities for visitors' boats, as well as those with moorings on the Canal and river and this was agreed.

43. BUILDING COMMUNITIES TOGETHER

A presentation was received from Ms. Susan Powell, Building Communities Together Team Manager, WBDC. She outlined the structure, the membership and the activities of the Team and answered questions from members.

The Chairperson, on behalf of the Committee, thanked her for her interesting and useful presentation.

44. NEWBURY IN BLOOM

The minutes of the Newbury in Bloom Working Group of 13 September 2018 & 18 October 2018 were noted.

The Chairperson thanked the volunteers and Newbury Town Council's Grounds Maintenance Officer, James Heasman for their involvement and organisation of a successful community bulb planting day which was held on 2 December 2018.

45. MARKET WORKING PARTY

45.1 The minutes of the Market Working Party of 1 October 2018 were noted. Councillor Martha Vickers, Chair of the Working Party, thanked the Community Services Officer, Caroline Edmunds, for all her work on the market promotional events on the 8th December. She urged members to support the market and presented the Action Plan for approval.

45.2 PROPOSED: Councillor Margo Payne
SECONDED: Councillor Jon Gardner

RESOLVED: To approve the Action Plan for the Market.

46. DETAILED SERVICE PLANS

The Service Plans were considered by the Committee and agreed.

47. SERVICES REVENUES FOR 2019/20 FINANCIAL YEAR

PROPOSED: Councillor Adrian Edwards
SECONDED: Councillor David Fish

RESOLVED: That there would be a 2.5% increase in Cemetery Charges for 2019/20 financial year.

PROPOSED: Councillor Adrian Edwards
SECONDED: Councillor David Fish

RESOLVED: That there would be a 2.5% increase in Market Charges for 2019/20 financial year.

PROPOSED: Councillor Adrian Edwards
SECONDED: Councillor David Fish

RESOLVED: That there would be a raise from £63.22 to £64.80 (2.5%) for senior pitches and continue with no charge for junior pitches for 2019/20 financial year.

PROPOSED: Councillor Adrian Edwards
SECONDED: Councillor David Fish

RESOLVED: That for the 2020/21 financial year for Newbury Parish Residents there would be an increase from 34.7p per sq. metre to 36p per sq. metre (equivalent to £9.00 per pole).

RESOLVED: That for the 2020/21 financial year for Non-Residents of Newbury there would be an increase from 69.5p per sq. metre to 72p per sq. metre (equivalent to £18 per pole).

PROPOSED: Councillor Adrian Edwards
SECONDED: Councillor David Fish

RESOLVED: That for the 2019/20 financial year the Annual Family Membership for the Victoria Park tennis courts is increased from £36 per annum to £44 per annum with no increase for the floodlighting or 'pay and play' charges.

39. REVIEW OF COMMUNITY SERVICES 2017/18 BUDGETS

The Committee considered the draft budget for Community Services, as prepared by officers and agreed the draft, as presented.

The meeting also considered the proposals received from Members, and agreed as follows:

- The proposals to floodlight the football pitch in Victoria Park: It was agreed to defer this matter for further consideration after the changing rooms have been provided, when the council can better understand the demand for such facilities and to review in 2020/2021.
- Water Tap in Newtown Road Cemetery: It was agreed to investigate costs for this to consider making provision for this in the draft budget.
- Thermal imaging of the Town Hall: It was agreed to investigate costs of this to include in the draft budget.
- A sessional Youth Worker to support and develop Newbury Youth Council: this proposal to be discussed with members of the Youth Council and, if agreed, to be referred to the Policy and Resources Committee thereafter.
- The provision of recycling Bins in the Town Centre and Victoria Park: it was agreed that for large events in Victoria Park, recycling facilities would be investigated.

PROPOSED: Councillor Adrian Edwards
SECONDED: Councillor Howard Bairstow

RESOLVED: That the proposed draft Community Services budget, as amended above, is submitted to Policy & Resources Committee for consideration on 14 January 2019 as set down in Appendix 6 of the Agenda.

Cllrs Arthur Johnson and Martha Vickers abstained from the vote.

48. ALLOTMENT STEWARDS MEETING

The minutes of the Allotment Stewards Meeting held on 30 October 2018 were noted.

49. NEWTOWN ROAD CEMETERY WORKING GROUP

The minutes of the Newtown Road Cemetery Working Group held on 13 November 2018 were noted.

50. FORWARD WORK PROGRAMME FOR COMMUNITY SERVICES COMMITTEE MEETINGS

The Forward Work Programme was noted.

51. EXCLUSION OF THE PRESS AND PUBLIC

PROPOSED: Councillor Adrian Edwards
SECONDED: Councillor James Fredrickson

RESOLVED: That under Section 1, Paragraph 2 of The Public Bodies (Admission to Meetings) Act 1960 the press and public be excluded from the meeting for the following items of business (agenda item 18) because publicity would be prejudicial to the public interest by reason of the confidential nature of the business to be transacted.

(Councillor Sarah Greenall left the meeting and Councillor Howard Bairstow chaired the rest of the meeting.)

52. NEW CAFÉ AND SPORTS CHANGING ROOMS FOR VICTORIA PARK

An update was received from the Chief Executive Officer on the proposal for the construction of a new café and sports changing rooms for Victoria Park.

53. DISPOSAL OR LEASE OF LAND AT FIFTH ROAD

Members considered a report from the Chief Executive Officer regarding a proposed transfer of part of the Council's lands at Fifth Road for a project with potential community benefits.

PROPOSED: Councillor James Fredrickson
SECONDED: Councillor David Fenn

RESOLVED: That Newbury Town Council retain the Freehold of the land at Fifth Road and instruct Officers to explore with West Berkshire Council a reciprocal agreement whereby Newbury Town Council may offer a 25% discount for the lease of the land, and West Berkshire Council reciprocate with a discount on the clawback provisions as set out in the transfer of the land from WBDC to Newbury Town Council on 3 February 2003.

THERE BEING NO OTHER BUSINESS THE CHAIRPERSON THANKED ALL THOSE IN ATTENDANCE AND DECLARED THE MEETING CLOSED AT 8:50pm.

CHAIRPERSON

Newbury in Bloom Working Group

Town Hall, Suite 2, Thursday, 20 December 2018

Minutes

PRESENT: Councillors Sarah Greenall (Chairperson); David Fenn; Charlotte Beaven (Deputy Youth Mayor); James Heasman (GMO - NTC); Tony Hammond; Fran Lawton and Fiona Walker.

1. APOLOGIES

Councillors David Fish; Martha Vickers; Margo Payne; Howard Bairstow; Kuldeep Singh Kang; Marion Fenn; Paul Barker and Samantha Carpenter.

2. MINUTES TO BE APPROVED

The minutes of the meeting of the Newbury in Bloom Working Group held on 18 October 2018 were approved.

3. NIB NEXT YEARS CATEGORIES

The group agreed to pursue the Best Street and canal boat floral display for this year's campaign on top of current Newbury in Bloom Categories.

It was agreed that the schools category needed the most expansion and pushing in the coming year. Hugh suggested that we put pointers in the letter for prospective schools for the coming year.

Action- James and Sarah produce letter to go to schools in January to give them the earliest possible opportunity to take part

David explained there is a trophy in the Town Council stores that was previously provided by Fishers and maybe worth re-instating.

Action- James agreed to approach to see whether they would be interested.

4. BIB AND ROUTE UPDATE

James produced a map and route and proceeded to brief the group on the route for next year's Britain in Bloom judging. The group agreed on the route after 2 minor changes and also agreed it was worth involving One Tree Park Allotments. The Planter on Lock Island was discussed to permanently house Growing Newbury Greens edible plant project, It was also suggested that we could have a band on the bandstand at the final part of the journey.

Action- James agrees to Pursue One Tree Park Allotments for their involvement.

Action- James meet Tony in January to discuss siting and also Contact 3rd Newbury Scouts for shrub planting and Lock Island planter building.

Due to the need for their support on the judging day it was felt that we should invite Andrew Marmot (CM Parkway) and Paul Hendry (WBC Grounds Maintenance manager) to see how they can assist with bringing the route up to standard.

5. COMMUNITY PROJECTS

Sarah enforced the need for us to involve youth groups especially 3rd Newbury Cubs.

Fran had explained that there was a group of ladies at Wash Common who were keen to do something similar to the bee meadow at Monkey Marsh.

Action- Fran to follow up interest and James will find suitable sites in the area potentially WBC sites.

The group agreed that we should look at how money was spent across the categories and maybe donate tools and resources to valuable causes to work towards Britain in Bloom.

Fran asked whether it would be worth contacting BBOWT to help support in the wildlife section of Britain in Bloom where relevant.

Action – Fiona explained she had contacts within BBOWT and would contact them to see if they would be interested.

6. BULB PLANTING FEEDBACK

Sarah thanked everyone involved for the successful event and commended the turn out on the day.

Sarah asked that there was more provisions of tools and refreshments for children for these events. The need for a dedicated photographer was discussed it was felt that working group members could share this role on the the day.

A comment that the social media needs to be better promoting these events was put forward by the group and that this needed to look into it.

Action – Hugh and James to review social media and deal with accordingly

7. AOB

Charlotte explained that there was likely to be an amount of money from the Newbury Youth Council towards the Sensory Garden.

The shrub planting dates and times were confirmed as the 16th March and would commence from 11.00 am.

Action – James meet Fran in new year to discuss shrub options

8. NEXT MEETING

The next meeting is scheduled for Thursday 24th January 2019 18.30pm.

Newbury in Bloom Working Group

Town Hall, Suite 2, Thursday, 20 December 2018

Minutes

PRESENT: Councillors Margo Payne(Acting Chair); David Fenn; Martha Vickers; Howard Bairstow Charlotte Beaven (Deputy Youth Mayor); James Heasman (GMO - NTC); Tony Hammond; Paul Barker and Fiona Walker.

1. APOLOGIES

Councilors Sarah Greenall; David Fish; Kuldip Singh Kang; Marion Fenn; Fran Lawton and Samantha Carpenter.

2. MINUTES TO BE APPROVED

The minutes of the meeting of the Newbury in Bloom Working Group held on 20 December 2018 were approved.

3. NIB PROMOTION AND ADVERTISEMENT

The group agreed to continue with the social media campaign the same as previous years with horticultural tips promoting the Newbury in Bloom campaign, this should commence from the 28th February to get as many people interested as possible.

Also it is requested that the application pack and poster is ready by the next meeting on the 26th February to make any minor amendments that maybe needed

Action- James agreed to progress the promotions with the suggested time constraints onto corporate services for completion.

Howard suggested that we do an article in the local press regarding Britain in Bloom and our involvement in the competition this year and also that it would be worth inviting the press to the information evening in February.

Action- James agreed to progress

4. BIB AND ROUTE UPDATE

The group agreed the amended route with the addition of St Nicholas church being involved and added to the route. On confirmation that the timings are capable this would be our route for this year's competition.

Action- Paul and James will do a run through of the route and time it to check we are able to incorporate all elements.

Action- James agreed to put an action Plan together for the next meeting based on the findings.

5. SHRUB PLANTING 16th March 2018

James explained the details of the shrub planting which would start in Victoria Park and the progress to Lock Island, a list of shrubs were discussed by the group that had been put together by Fran and James. A figure of £1000 from the Newbury in Bloom additional floral displays budget was agreed as an acceptable figure for this venture.

Action- James agreed to contact Sarah regarding 3rd Newbury Cubs involvement and a contact.

Action- Charlotte agreed to approach the youth councilors for them to be involved in the planting.

David explained he had a contact from Vodafone who has a group of friends who may be interested in volunteering.

Action- David to follow up interest.

6. **GROWING NEWBURY GREEN BED LOCK ISLAND**

James and Tony explained that they had met and agreed to put in a 2x3m sleeper constructed bed to be situated next to the seating area for Growing Newbury Greens display this year.

Action- James to contact Sam about soil for the bed

7. **BRITAIN IN BLOOM INFORMATION EVENING**

James explained the background of the information evening in approaching the key parts to the route to come and gain information on how they will be involved. Also to network and gain knowledge from our experts to help with their part.

It was to be held on Wednesday 13th February commencing from 7pm including a 20 min presentation and then a Q&A section followed by an opportunity to network and refreshments afterwards.

Action- Tony to invite Lock Island action group to Britain in Bloom information evening

8. **AOB**

Margo and Fiona asked whether a WBC representative could attend the next meeting.

Action- James to ask Paul Hendry to attend next meeting

9. **NEXT MEETING**

The next meeting is scheduled for Tuesday 26th February 6.30pm.



**MINUTES OF THE MEETING OF
THE MARKET WORKING PARTY
held on Monday 28 January 2019 at 10 am
in the Elsie Kimber Room, Town Hall, Market Place, Newbury**

In Attendance:

Cllrs Adrian Edwards, Jeanette Clifford, Margo Payne, Martha Vickers (Chair); Debbie Smith (Market Manager)
Hugh Peacocke (NTC CEO)

1. Welcome/Apologies/Introductions

There were apologies from Cllrs Jo Day, John Gardner and Kuldip Singh Kang, Caroline Edmunds (NTC Community Services Officer) and Emily - Manor Farm (eggs)

2. Minutes & Matters arising from previous meeting 1 October 2018.

The minutes were agreed as correct.

Matters arising:

1. New logo circulated and agreed.

Actions:

- To be publicised: notice boards, bus shelters, Bus Terminal, Kennet Centre, Penny Post.
 - Send to all members, inviting them to print and display on suitable notice boards in their ward, tweet and promote.
 - Advertise/ promote the market in the Library and on the buses (get costs).
 - Cllr. Payne to contact Kennet Radio to interview Market Manager.
 - Promote the messages re plastic and waste reduction by using the Market.
 - CEO to send new logo to PR distribution list, inviting them to get back to us re Market
 - Get the BID to use the new logo on Visit Newbury
 - Flyers into stone building café
 - Cllr. Vickers to give flyers to Empire café
 - Take proposal to Community Services Committee that Cllrs. Distribute flyers at the bus terminal.
2. WBDC and compensation for loss of trade during market place re-paving
CEO wrote to WBDC who responded that this would not be considered.
 3. NTC wrote to all traders inviting ideas for Christmas promotions/ events – only one response received.

3. Market Manager's Update

Debbie updated the group, points to note include:

- New hospitality gazebo working very well and helps to improve appearance of the Market
- In common with other markets across the region, Christmas trade was disappointing.
- The events on 8 December were well received, especially the brass bands

Actions:

- New stalls expected in February- arrange PR to announce/ promote market
- A Boards for market news/ trader updates, etc.

4. NTC Update

- The Action plan, as recommended by the MWP, was approved by Community Services Committee on 10 December 2018.
- Marketing budget: £100 remaining for 18/19. £2,500 in 19/20 budget.
- Large posters to replace posters in car parks and bus shelters. Looking at the Kennet Centre.
- Traders invited to send social media links to Council to be added to their profiles on NTC website
- Rents to increase by 2.5% from 1 April

5. Future promotional events and ideas

- Caroline will book music, face-painting, town crier.
- Spanish theme on day of Carcaxient twinning? (July)
- Publicise opportunity for free stall to promote charities, sports clubs and other not for profit organisations/ events
- The Chair proposed that we invite a story teller
- The Chair proposed that we have a free stall for residents/ allotments to sell their produce but concerns were expressed that this might be competing with existing stall holders who pay a rent. (Post-meeting comment- the idea contravenes allotment law and various trading standards)

6. Date for next meeting.

1 April 2019

Meeting closed at 11.30 am

Newbury Town Council

Public Report

Community Services Committee, 11 March 2019

Agenda Item No 10

Community Services Manager Report (5 March 2019)

1. **Town Hall Chamber**
The refurbishment of the timber panelling in the Town Hall chamber has been completed. The walls have been repainted and the decorative columns and mouldings have been enhanced.
2. **Town Hall Carpet – Civic Staircase, landings and foyer**
Quotes have been received and a supplier has been instructed to install a new carpet to these areas.
3. **Town Hall – Civic Staircase and foyer**
This area has been repainted and the timber panelling refurbished.
4. **Town Hall External Lead Flashing and Guttering**
Contractors accessed the difficult to reach roof sections above the Town Hall Civic stairs and Suite 6 to enable a full inspection of the lead flashing, roof tiles and guttering and carried out some minor repairs required.
5. **Victoria Park Lighting**
Works have been completed to install 7 new lighting columns and 8 wall mounted lights along the pathway at the Nursery school end of the Park.
6. **Victoria Park Pedalos Protection**
Plans are in place to install a protective wooded lip on the top of the small wall around the pond in an area near to the boat store to protect the underside of the pedalos when being lifted in and out of the pond. Works will be completed before the spring.
7. **City Recreation Ground Pedestrian Pathway**
Plans are in place to refurbish and widen the pathway between Rectory Close and Buckingham Road. A WBDC Members' Bid has been submitted in an attempt to secure match funding for the project. The balance of the funding could come from I come from Newbury Town Council CIL or section 106 funds.
8. **Play Equipment and Surfacing**
The annual external inspection of Playgrounds & equipment has been carried out by The Playground Inspection Company Ltd. The outcome is currently being analysed and works needed to meet statutory compliance is being prioritised & implemented. Some in year additional funding may be required.
9. **Grounds Maintenance Contract**
The annual review of the Grounds Maintenance Contract between West Berkshire Council, Newbury Town Council & Continental Landscapes Ltd was held on 5th Feb 2019 Chaired by WBC. Overall, following the initial settling in period, it was agreed the Contract was being delivered as Tendered, the outcomes generally in line with the performance specification set out by Newbury Town Council.
10. **Victoria Park – Sensory Garden**
A renewed effort is in progress to secure additional funding for this project with an approach to the National Lottery Community Fund. A business case for additional Grant funding has been submitted for Grant consideration.

11. Town Hall – Mayoral Name Boards

Newbury Town Council is assessing the ongoing deterioration of the wall surface in the Council Chamber which in turn is affecting some of the older Mayoral Names on the Name Scroll Board. Specialist Historical Manuscript Artists have been contacted to give view on the current decay and options for preservation and or replacement of these panels.

Recommendation: Member to note progress being made by the Community Services Team on various Newbury Town projects.

Signed: David W Ingram, Community Services Manager

Date: 5th March 2019

Newbury Town Council**Public Report****Community Services Committee, 11 March 2019****Agenda Item No 11****City Recreation Ground – Public Consultation****To consider** the outcome of the Public Consultation in respect of f City Recreation Ground**Background:**

Newbury Town Council Strategy 2018-201 sets out in its short term Projects, 01. STP4 – Consult residents in the area and prepare a plan for the development of leisure amenity facilities at City Recreation Ground.

Following the completion of the repairs to Victoria Park the council can now consider the longer term future and planning of the other major recreation grounds and open spaces which are provided for the community. It was decided to consult the public regarding their ideas and views on the City Recreation Ground before embarking on any long term plan or strategy for the facility.

Members will be aware that the Public Consultation began with a letter drop to Residents around the City Recreation Ground area in mid July 2018. It was as a result of this Consultation that residents suggested that the use of the Open space was well beyond the local area and a wider Consultation would be more appropriate. The Consultation was therefore extended, advertising more public and an advert taken out in the Newbury Weekly News. There was also an online survey on the Council's website. The consultation closed on 28th February 2019.

The questions posed were as follows:

Newbury Town Council is seeking your views for the enhancement of the recreation ground and having already sought the views of the immediate residents surrounding the area, appreciate that it is also used by other residents of Newbury.

1. **Do you use the Recreation Ground, and if so, what for?**
2. **Would there be something that would encourage you to visit more often?**
3. **Do you support a proposal for a junior cricket pitch on the grounds?**
4. **Do you have any ideas that would enhance the area?**

Objective

To ensure that any future planning and investment into City Recreation Ground has public participation and meets the residents' expectations.

Outcome:

There was a high level of responses to this consultation, which demonstrates the importance of the recreation ground to the Community. In the initial consultation last summer we received 9 written responses. This time around, extending the consultation to the general public, we received 38 online responses, as well as 11 written responses from students at Newbury Hall School.

Appendix 5a shows the summary of responses from all of the returns which have initially been considered by Officers and which suggested a priority list of the following matters:

- A. A safer and more secure Environment
- B. Enhanced facilities
- C. Playgrounds
- D. Other sports and Leisure
- E. Environmental
- F. No Change

Reference to Council Strategy, where relevant

The Council Strategy includes the following objectives:

- 01.6 - Maintain and run high quality parks, playground and leisure spaces/facilities
- 01.16 – Encourage & facilitate resident's participation in social recreational and sporting activities.
- 01. STP4 – Consult residents in the area and prepare a plan for the development of leisure amenity facilities at Coty Recreation Ground

Options

All of the Council's Parks and recreation grounds need constant maintenance and investment. In the long term interest of the community and to ensure best value for money, it is important that this is carried out in a planned and strategic manner. This requires that the Council is aware of the needs and wishes of the community. The consultation responses are varied, including the option of retaining the City recreation ground in its present format and uses.

Officers will consider the consultation responses and the wishes of Members and return with a long term strategy for the future of The City Recreation Ground. When approved, we can consult the public again before final adoption and implementation.

This will enable the Council to maintain the facility and plan and invest in its future in the best interests of our communities.

Recommendation(s)

- A. Members to note the initial outcomes from the Public Consultation.**
- B. Officers are authorised to prepare a long term plan for the future of the City recreation ground, having regard to the outcomes of the public consultation.**

Signed: David Ingram
Community Services Manager

5 March 2019

Summary of City Recreation Ground consultation responses:

A safer and more secure Environment:

1. Lighting
2. CCTV
3. Control of dogs
4. Protection for pedestrians
5. A new wider path all around the edge
6. The Andover Road entrance/exit would benefit from a gate as it's a potential hazard for dogs off lead in the park.
7. More bins, dog poo bins
8. Dog area (enclosure)
9. Missing children area
10. Tackle Anti-Social Behaviour

Enhanced facilities:

11. Public toilets
12. A kiosk or a vending machine
13. Bike hire/ Bike secured racks
14. Creating some short stay parking on the green space in Andover road near Willow Close would be helpful to residents and visitors
15. Seating and picnic tables; more seating at north/south edges
16. Walking route to/from Town centre

Playgrounds

17. A zip wire and a larger slide, perhaps a sunken trampoline.
18. An adventure playground for older children
19. Water/paddle area for children
20. The playground would benefit with an increase in size to accommodate more children to play at the same time (more swings, roundabouts, rocking things).
21. The ground should be similar that to the surface of Victoria park kids playground (soft rubbery material).
22. A general overhaul of the current equipment, as some of it is old, dated and faded

Other sports and Leisure

23. Gym/ Outdoor fitness equipment
24. Football facilities for younger children and 5 a side
25. Tennis
26. Cricket
27. Basketball hoops

- 28.Soccer cages
- 29.Running track

Environmental

- 30.Extra planting, incl. British herbs, flower beds, fruit trees
- 31.The planting of more beneficial hedging , verges and wild flower areas
- 32.Small parts could be set aside for wildlife by protecting existing wildlife habitats and encouraging new ecosystems which bear a wider range of wildlife
- 33.Nesting boxes in trees and on the building (swift boxes).
- 34.'Grow more and mow less' and use this site as a model for how you intend to manage your lands and buildings in future to help combat climate change and the effects of human presence on other species.
- 35.Children could be involved in undertaking wildlife surveys and audits to judge progress
- 36.A small pond would also bring another dimension to the ecosystems
- 37.Think outside the box of human use of this lung of green land and think wider to get on board with the increasing realisation that urban and sub-urban areas are just as import as the countryside. Please take the opportunity to expand on your orchard initiative and go much further with the design of this green lung for for the benefit of non human species, as we must share our lands.
- 38.More shade/ canopy (Trees or Canopy)

Other

- 39.I suggest that we leave the park as it is and spent our money on more pressing things.

CITY RECREATION GROUND RESIDENT CONSULTATION RESPONSES (Summer 2018)	
1	<p>I am writing to ask if it is possible for some extra park benches to be placed along this park. It is enjoyed by so many people especially in the warmer months and the only two benches that are there are located around the children's play park. Sometimes when the football is on there is nowhere to sit to relax and enjoy a local game or likewise just sitting for the enjoyment of watching the dogs walkers letting their dogs play together.</p> <p>The shady area under the trees that stand there would seem to be an ideal place too.</p> <p>For and on behalf of the park enjoyers</p>
2	<p>We think the City Playground would benefit from a new wider path all the way round.</p> <p>We believe the dog waste bins are too close to the path which makes them an obstacle to pedestrians and would be better placed further into the green. The dog waste bins have also been put too close to the end of gardens, and it is our experience that the lids are too noisy.</p> <p>Anything that encourages groups of people to stay in the park into the night, could be a source of anti-social behaviour.</p> <p>The return of the neighbourhood wardens would be reassuring.</p>
3	<p>I am happy with the park, except that I would like the low hedge removed outside the back of my property. It just serves as a place to throw rubbish, and for people to sit behind, smoking and taking drugs.</p>
4	<p>We have been very impressed with the construction of the wider footpath on the eastern side of the Recreation Ground earlier this year – and would like to congratulate the Town Council on their funding of this project. Would it be possible to construct a similar, wider footpath on the northern side of the Recreation Ground? The existing path is damaged and uneven in places. There is also a narrow bottleneck where the path meets the third side of the triangle in the north-west corner. Cyclists continuing through to Buckingham Road and St. Bartholomew's School would benefit from an improved pathway.</p> <p>Some trees and hedges on the western side of the Recreation Ground are overhanging the footpath – restricting access in places. Perhaps the Council could remind residents of their responsibility to maintain their boundaries?</p> <p>We have noticed this summer that there is a lack of shade in the Recreation Ground. As we have been told to expect a changing climate and hotter summers in the future, might it be possible to plant more trees on the edges of the field, being mindful of the location of the popular football pitch?</p> <p>We would like to see a higher standard of horticultural skills practised by the contractors employed in the maintenance of the Recreation Ground. For example, not cutting back daffodil leaves while still green or strimming wild flowers around the apple trees.</p>
5	<p>Newbury Town Council has embarked on work to improve the surface and possibly widen the footpath running behind the Andover Road houses in the City Recreation Ground, Newbury. I understand this is to improve conditions for cyclists. I have no problem with cyclists using the park as a safer route as long as they give due regard to other users of the park.</p> <p>I believe the intention is to do similar work along the Footpath behind the Rectory Close houses. Over the years the hedges of the houses in Rectory Close have been allowed to encroach onto the pavement and are now several feet thick. If these hedges were drastically cut (before the nesting season starts!) the original path line could be re-established. Whatever the Town Council does in the park area I believe the section of path running past 69-75 Rectory Close and which exits onto Buckingham Rd is far too narrow for joint use and that cyclists should dismount to prevent a pedestrian being injured. For a long section of the path behind Rectory Close the gates to the gardens are concealed and a speeding cyclist would not be able to see a child coming out to use the park.</p> <p>If both of these Public Footpaths are improved for the use of cyclists presumably that would change their status. If they became Bridleways then horses could use the park as well. If the Town Council advertises the use of the paths for cyclists then that could make life difficult for all other users of the park, particularly children, as the cyclists may not remember where they are and think they have the right to take priority. Would it help to have signs expressing 'Pedestrian Priority' as there are on sections of the canal towpath?</p>
6	<p>My suggestion for the enhancement to City Recreation Ground is to make it a safe, enjoyable place for EVERYONE to enjoy.</p>

	<p>My first idea would be to have a bench seat with a canopy over. Not everyone enjoys sitting in direct sunlight.</p> <p>Secondly to make it compulsory for dog walkers to keep their pets on a lead.</p> <p>On several occasions I have been involved in extremely frightening situations where dogs not under control (on a lead) have terrified me. Fortunately I have not yet been bitten or knocked over but it's only a matter of time.</p>
7	<p>I am wondering why the City Recreation Ground needs enhancing. Is it an idea of The Town Council or has it been suggested by residents. What is wrong with the recreation ground at present? The area is about the only area of relative peace in the town centre. It certainly does not want to become another Victoria Park. The footballers seem quite happy and there is a very nice play area for the small children. People walk their dogs and all is fairly peaceful. The small orchard is growing nicely as is the small bunch of trees. Inter office rounders games are played in the summer evenings to much delight. The park has been there for many years and in the 41 years that I have lived here I have heard of no suggestions that it should be changed. I suggest that we leave the park as it is and spent our money on more pressing things.</p>
8	<p>Having lived adjacent to this park for some 40 years we have watched changes with interest. We see this area as an informal one where formal flower beds would look out of place. The current fashion for cutting all shrubs straight as if they were a hedge seems totally inappropriate here and those that have been left to develop naturally to show their true character fit the space perfectly and can now give greater pleasure to users of the park and benefit wildlife. However, the cutting down far too early of leaves of daffodils planted by volunteers will lead to a lack of flowers next year and a gradual decline in vigour. Jenny has liaised with you in the past about creating a wild-flower bed (possibly in front of the cottages in Hampton Rd or in the wider verges behind Rectory Close) which would fit with the informality of the space, give pleasure to users of the park and enhance its value for wildlife. Some of the shrub beds could be totally removed unless they are properly weeded or maybe replanted.</p> <p>In many areas where new trees are planted they are very quickly vandalised. When the 'plum copse' and shrub/tree beds near the play area in the City were planted by Newbury District Council these were immediately surrounded by quantities of manure. This obviously benefited the plants but also acted as a deterrent and the area was left totally alone. Perhaps this technique could be used if new trees are planted to avoid wasting money. We also believe that no tree-planting should take place without a clear plan for their care/maintenance; we have seen many trees not watered during dry spells in their first 2 years and the failure to adjust or remove ties, thus strangling the tree, again wasting money.</p> <p>It is not uncommon for residents in the roads surrounding the park to be disturbed during the night by people noisily walking home from town through the park, using the park as a meeting place for loud chats, playing music, or having games of football by moonlight. Occasionally this good-humour spills over into something which sounds much more aggressive. All of this disrupts sleep and, with the extended licensing hours, can go on until 4am. For this reason we would strongly object to anything that would encourage use of the park when the rest of us are trying to sleep. This would apply to increasing lighting or equipment specifically designed for use by young adults.</p> <p>We understand that local residents have a legal duty to maintain their hedges to allow access along public footpaths but are unsure of their obligation to allow access along the path behind Buckingham Road as this is not a public footpath. We have already liaised with about plans to improve the path along the back of Rectory Close. As motorbikes already occasionally access the park along the path from Buckingham Road it is absolutely vital that steps are taken to maintain the safety of residents and users of the park in this area.</p> <p>As mentioned before we see this park as belonging to all residents of Newbury, not just those who are lucky enough to live close to it. We would like to see notices at the entrances to the park and on the play area inviting people to contribute to the discussion.</p>
9	<p>We would appreciate it if a suggestion for an Adventure Playground for older children could be added to September's committee meeting agenda for review.</p>

Do you use the Recreation Ground, and if so, what for?
Yes. My kids use the play park, we cycle and run around it. Play football there too. In the summer we have the occasional game of rounders with the street!
Dog walking in the main and evening walks in summer and autumn. Watching the football as and when my walks coincide with matches.
Yes - Dog walking, running, cycling, picnics, football, playground & general play area for my children
Yes, used daily for dog walking and the children's playground
Living in Rectory Close as a family we have used this for the play park for playing football, it's now a route to walk to school. Previously it was the home pitch for a football team I played for and potentially it could be the home pitch of a football team I coach when they are older
Playground and playing in the field
I walk for fitness round it every day
running and use of the pathway to walk to town.
Dog Walking / shortcut
dog walking
Yes, dog walk and playing football and cycling with kids
Playing football with our children. Walking the dog.
Yes, for the park.
Regularly, but mostly as a route between home and town.
We occasionally walk our dog, I cycle to work and use the cycle path
Yes, the park is well-used daily by teachers and students of Newbury Hall school for walking, football and other leisure activities like rounders, cricket and frisbee.
Daily dog walk. Also take visiting children to the play area.
Cycling, football with kids and play area for kids
Park, football, cycling, jogging
Yes with my two young children for the park and bike/scooter trips
I do regularly use the park (3/4 times a week) to walk my dog. I also use the children's park about once a week.
Yes we live in Rectory Close our children use the playground and the cycle path
Scouting on the path, flying kites, playing football, children's park
My wife and I have taken my 3 year old daughter to use the playground and use it as a cut through when walking towards the town centre.
Yes
We use the playground and the footpaths for bike riding with our toddler.
Play area for children. Safe way to cycle or walk to town from south.
I currently use the Recreation Ground for walking my two dogs. I live on Buckingham road so its a super convenient outdoor space. I'm also hoping to use the playground when my son gets old enough, should said playground not still be used for recreational drug taking and drinking in 2-3 years time.
Dog walking
Talking my son to the park, walks, watching the football matches.
Yes, for walking. As a suggestion, when you engage in these public consultations it would be useful to see a map of the area as a starting point, as not all residents know the correct name for each piece of land that NTC owns or manages. ie. people refer to 'recs' not always knowing that there are others nearby.

Would there be something that would encourage you to visit more often?
Make it harder for motorbikes / scooters to whizz down the path.
Could consideration be given to the provision of more seating particularly along the northern and south eastern edges. Currently there is only one seat on the south west side near to the play area which faces east and is in shade for most of the time in the afternoons and evenings. Provision of seating in the sunshine (especially evenings) would greatly increase the enjoyment of the park. I am sure that three or four more bench seats would be appreciated by all Newbury people and others who visit. These seats should face into the park to maximise enjoyment.
Yes, less anti social behaviour such as noise in the evening
It desperately needs lighting as the pathways are incredibly dark throughout winter. There is a big problem with anti-social behaviour and a pot-smoking culture. Teens regularly hangout behind the changing rooms and the park bench next to the childrens playground smoking pot in broad daylight.
If the goals had nets on permanently that would be great. A basketball 1v1 space. The grass being cut more regularly.
A playground for older children e.g adventure playground
If the other 2 paths were sorted for walking more safely.A lot from elderly living walk with walkers and itâ€™s not even for them.i would also like the bushes and trees trimmed back from the path more often as you end up hooked to them as you pass
More benches / picnic benches. A drinks kiosk.
more seating and picnic tables
Park is more for toddlers. . Older kids playground and gym/exercise equipment
Flowerbeds
Public toilets. As far as Iâ€™m aware, the closest toilets would be in the Kennet Centre, unless you live nearby. Probably unrealistic, but a proper sit-in cafe, open all year around and not just in the spring / summer like the hut in Victoria Park.
My elderly mother previously used it as a walking route and laments the removal of benches as a resting point
A seating area with picnic tables
Better play area - can get very muddy More seating areas
More places to sit, esp in the playground area. Wider paths, like the new one that was upgraded last year but all the way around.
More dog bins or cctv or a visiting dog warden! The grass areas are a no go area for my children as it is full of dog foul. It is disgusting and this really puts me off going around the edge of the park we tend to stick to the new wider path. An update of the play equipment at the entrance near the seesaw would be nice.
Yes, it would be lovely to develop the childrenâ€™s park to include a zip wire and a larger slide, perhaps a sunken trampoline. Also junior basketball/ netball nets would be great. It would also be really nice to have 3 or 4 picnic tables and extra benches around the childrenâ€™s park.
Bigger park area so thereâ€™s more to do
Older childrenâ€™s play equipment?
Better kids playground facilities, with more apparatus suitable for kids ranging from 1-10 year olds. Smaller (5-a-side) pitches and goals more suitable for younger children.
No
Wider paths all the way around. New/more things in the playground.

Flowering areas. Other sports facilities. Picnic area seating.
Yes. My single biggest criticism for the Recreation Ground is that it seems to be a hot spot for teenagers and young adults to take drugs and drink. There have been numerous occasions where I have been in the park and have witnessed multiple people huffing Nitrous Oxide from balloons and smelt the distinctive smell of weed in the air. On one occasion I found a pill in a baggy directly on the path towards the playground. I find this abhorrent, dangerous and anti-social, especially so as these activities often take place next to the playground and on occasion when there are children playing in there. No parent on their own, would wish to confront said group. Second to this would be the lack of lighting in the park. This compounds the above problem. I refuse to use the park in the winter outside of daylight or twilight hours. Irrespective of how safe this area feels in the day even with recreational drug users present, I refuse to take the risk as it goes dark.
More park benches/picnic benches
More playground equipment for older children.
Yes, this recreation ground has much potential to become a more inclusive area for both humans and wildlife. Currently it seems to be managed mainly as sports arena, for human use. There is plenty of space to retain a sports pitch of some sort, however there is much potential to enhance the area for other species as there are barren areas which are under utilised for nature and could be easily enhanced. The area is surrounded by residential gardens and could usefully be a much better wild-life corridor by the planting of more beneficial hedging, verges and wild flower areas. Small parts could be set aside for wildlife by protecting existing wildlife habitats and encouraging new ecosystems which bear a wider range of wildlife. This would help support your plan objective 10.4 which is not well defined. To undertake proper hedge and verge use and planting you could involve local schools to help plant up and manage the areas, especially to enhance the ethos of the community orchard. A correct planting programme could help cleanse the air and it is a proven fact that hedging may be more beneficial in this respect than tree planting. I notice that a lot of the existing hedging is non native and not joined up. It would be possible to establish a hedgerow which could receive protected status for future generations and provide much better nesting opportunities for birds, and better breeding grounds and food sources for invertebrates. A small pond would also bring another dimension to the ecosystems, and planting of native bulbs would be more beneficial to early pollinators than cultivated daffodils. You could put up nesting boxes in trees and on the building (swift boxes). Children could be involved in undertaking wildlife surveys and audits to judge progress. You could 'grow more and mow less' and use this site as a model for how you intend to manage your lands and buildings in future to help combat climate change and the effects of human presence on other species. There are many initiatives that you could plug into such as the Plant Life scheme for council owned verges, RHS initiatives for schools, hedging incentives by the Woodland Trust. etc.etc. Need I go on? Please please think outside the box of human use of this lung of green land and think wider to get on board with the increasing realisation that urban and sub-urban areas are just as important as the countryside. Please take the opportunity to expand on your orchard initiative and go much further with the design of this green lung for the benefit of non human species, as we must share our lands.

Do you support a proposal for a junior cricket pitch on the grounds?
Yes, a great idea
Provided that this does not give rise to incidents and accidents with cricket balls and the general public. This may influence the age range able to play on a pitch?
I have not seen the proposal so that would depend on what it entails
I have no objection providing it does not become out of bounds for residents
No, this would take up too much space for too long a time.
No
Yes why not,
Depends on its location, boundary limits,safety of passers by and protection of fences of surrounding properties.
Yes
yes
No, I don't see the value in it. Could be issues with the ball and residents
Yes
Yes, as long itâ€™s located so that the balls arenâ€™t at risk of hitting others using the park.
Yes - sounds like a good idea if a decent surface can be maintained.
Yes. we should encourage all forms of sport/exercise for young people
Yes, provided it does not take up the majority of the open space and that it is open for everyone to use.
Not sure it would get as much use as a football pitch. Surely football is more popular and the pitch can be used any time by families and groups of kids.
Yes
No, this will take up valuable space that is currently used by dog walkers, families playing and having picnics.
Yes to avoid more dog fouling! Perhaps with shorter grass the owners will feel more ashamed to leave it.
Yes, absolutely
I think thatâ€™s a great idea. Anything to encourage children to be outside is good.
Yes
Yes
I do support a junior cricket pitch but not at the expense of losing the football pitch. However I question the frequency of junior cricket pitch use when football is a more popular sport and smaller 5-a-side pitches and goals would be used more.
No
So long as it doesn't impact on current use/users yes.
Seems a good idea. How would it be controlled?
I do indeed. But it will be a wasted effort if the above antisocial behaviour issues are not addressed. A cricket pitch would effectively provide a manicured patch of grass for the more fashion conscious/dirt averse drug user to enjoy.
Yes
Yes, absolutely
Only if the pitch area is subject to a control of dogs order with no domestic pets allowed onto the playing area. And only if it did not prevent planting as suggested above. Parking is an issue which restricts And the addition of a small grass-crete area for disabled parking would open up

Do you have any ideas that would enhance the area?
Better security patrols - after St Barts leave they litter, fight etc. In the evening youths, alcohol and motorbikes.
Drugs and underage drinking have been a nuisance in the past but I haven't been aware of such overt activity lately. It may be a good idea to arrange ad hoc security checks every now and again to nip any such activity in the bud at an early stage. There could be a problem with increased littering as the park becomes more popular?
A more secure environment. The park is great but sometimes frequented by drug dealers etc
It desperately needs lighting as the pathways are incredibly dark throughout winter. The Andover Road entrance/exit would benefit from a gate as it's a potential hazard for dogs off lead in the park.
Some low level lighting along the paths, it does not feel safe walking through in the dark. The Buckingham road entrance corner feels overgrown and not very pleasant. Creating some short stay parking on the green space in Andover road near Willow Close would be helpful to residents and visitors. Maybe some more benches. The changing facilities need refreshing.
An adventure playground for slightly older children than the current one accommodates
I would like a bit of colour some plants like primroses and bluebells that are in danger of disappearing would be nice. On the whole it's a nice park and I love doing my daily walk there
Growing more trees especially along the closeboard fences of properties on the south and south west sides of the park. The trees will be helpful to wild life and also protect the fences against footballs which often hit the fences during refereed matches and adhoc matches .
Flower beds.
more flowers and bulbs
Playground for older kids, adventure playground, exercise equipment.
Flowers, more seating
Picnic tables.
Benches. One at each corner looking inward.
Lighting along the new widened footpath/cyclepath would be a good enhancement. I cycle through on winter evenings and it is very difficult to see the few pedestrians, despite my bike having lights.
Picnic area with more seating away from the play park. Dog bins emptied more frequently.
Outdoor fitness equipment
Water/paddle area for kids Seating Improve play area - muddy and swings area old Park is in a very populated area with large number of children and 3 schools very close by.
Improve the policing of the area to decrease anti social behaviour and recreational drug use that goes on daily.
A new wider path all around the edge the old long path opposite the new path is very bad with barely any room to push a buggy and help a toddler ride side by side. More dog bins and free sacks as above. Some new play equipment with perhaps some water elements to spread the use from victoria park which gets too busy in the summer months. This would perhaps encourage footfall/travel up past the new developed end of town and away from the parkway helping smaller businesses and drawing families to both ends of the town.
More community police patrolling, as I have seen several drug deals taking place & smell marijuana being smoked.
I think the other path that runs parallel to Rectory Close should be improved. It regularly floods and is very uneven. I don't understand why it wasn't done when the other path was improved.
More trees/plants Make the hut look more attractive but stop youths from smoking!
The playground would benefit with an increase in size to accommodate more children to play at the same time (more swings, roundabouts, rocking things). Also a general overhaul of the current equipment, as some of it is old, dated and faded. The ground should be similar that to the surface of Victoria park kids playground (soft rubbery material). There should be improved lighting along the

pathways to deter anti-social behaviour and the pathways should be relaid similar to the shared use cycle and pedestrian pathway.

Wider footpaths

Trimming the hedges on the footpath from the recreation ground to Buckingham Road as well as the hedges on that side of the footpath inside the recreation ground leading up to the play area. The hedges are often leaning over onto the path.

Bike secured racks. Plenty of large dog poo bins.

Increase local police presence in the park to deter antisocial behaviour. I cannot stress enough how much of waste of time any gentrification project will be if the efforts are undermined by a few anti social and irresponsible people.

Flower beds

More lighting on the paths. People hang around there a lot, doesn't feel safe at times. More flowers.

25/02/19

Dear Sir or Madam,

I am writing in response to the public consultation on the city recreation ground. I would like to offer some ideas to help you to improve it.

Firstly, considering that Newbury has lots of elderly people, the park should be fitted with extra lighting in order to make them feel safe! As well as these lights walking paths should be resurfaced. In addition

to the new surfaces, a stand could be built where visitors or local people could hire a bike for some time, this would be a good way to

entertain yourself and your friends and family. Afterwards, people could buy a soft drink or a snack at the kiosk, close to the kiosk you would have picnic tables where the local community would be able to enjoy their drink while chatting with each other. A little bit of added vegetation, for example: plants, trees, this wouldn't harm the park.

Sadly, discarded litter has become a common sight, to resolve this issue, the park would benefit from CCTV cameras and an increase in number of waste disposal bins placed around the park. Council would be able to control this process, by fining people or sentencing them community service. Many people in Newbury have dogs, they often walk through this park, apparently some dog owners don't pick up their dogs excrement, which is unethical and illegal, CCTV cameras and community service would help us here. Newbury also has some young people, it would be a benefit for them, if the football pitch touchlines were to be repainted, as it has faded.

I hope you will consider implementing some of these suggestions.

Dear Sir or Madam,

25/02/2019

I am writing in response to the Public consultation on the use of City recreation Ground. Our class sat together and discussed some options to improve the quality of the park and the experience of those who are visiting it. Our suggestions would be that a kiosk could be added which would be a great thing for the people living there but also a profitable business for the council. In addition to the kiosk it would also be good to spread 4 to 5 benches around the park to offer especially elderly people, a seat if they need it.

Another idea could be to take some action against the dog poo problem by adding special bins to the park to reduce the amount of dog poo around or in the park to give it a better look, to make the area safer for people who are going out in the evenings. We came up with the idea to add streetlights 100 meters apart from each other around the park which would have a timer and would turn off at around 02:00AM, this would make people feel safer and could increase their satisfaction.

I hope that our suggestions were good and that you will use some of them.

yours sincerely,

Newbury Hall Student

Dear Sir or Madam

I would like to offer my suggestions of how the public consultation can improve the park.

Firstly you could add more benches to the park for the visitors. It will make help them to enjoy it more. With the help of the benches it will be easier for the elder and mothers with kids to pay attention to the kids and elder to enjoy the quietness of the park.

Secondly I would suggest adding more bins to the park so there would reduce the level of pollution. The park will be healthier and easy for the environmental care. The park will display fresh environmental look to the visitors.

Thirdly It would be beneficial if the Council improves the football pitch for the students and children who practice football.

In addition I would recommend an increase in the number of bins for dog poo. With the added bins the environment of the park would be more hygienic. It would be useful at the corner of the pathway toward the park to be a kiosk, which will help to the student who came from school to buy something small like water or chips for refreshments.

With these suggestions I hope we can change the park into a more welcoming and interesting place for the local community.

Yours sincerely,

Newbury Hall student.

Dear Sir/Madame,

I am a 15 year old English student at Newbury Hall and I am writing to suggest a few enhancements for the city recreation ground as you asked with the public consultation.

First I thought about a few installations to add to the park which could make it safer and more enjoyable. I would be grateful if you could add a few lamps along the park's edges. These lamps would ensure security for all pedestrians walking near the park at night. I also believe that trashbins would ensure a cleaner park and some british herbs could give a great fragrance to the whole park. Finally, the two last things to add, from my point of view it would be gym equipment and a vending machine near the changing rooms. With the football pitch, it would give Newbury citizens a good place to practice sports and have a way to relax after the effort.

I think that the second part of the park enhancements should be moving some of the already existing infrastructures to have a better space optimization and ensure the park is well-organised and even more beautiful. For a better comprehension, I suggest you take a look at the plan which came with this letter. The two biggest changes I would make are, setting on the children's playground along the left edge (on the plan) and replanting the already existing trees at

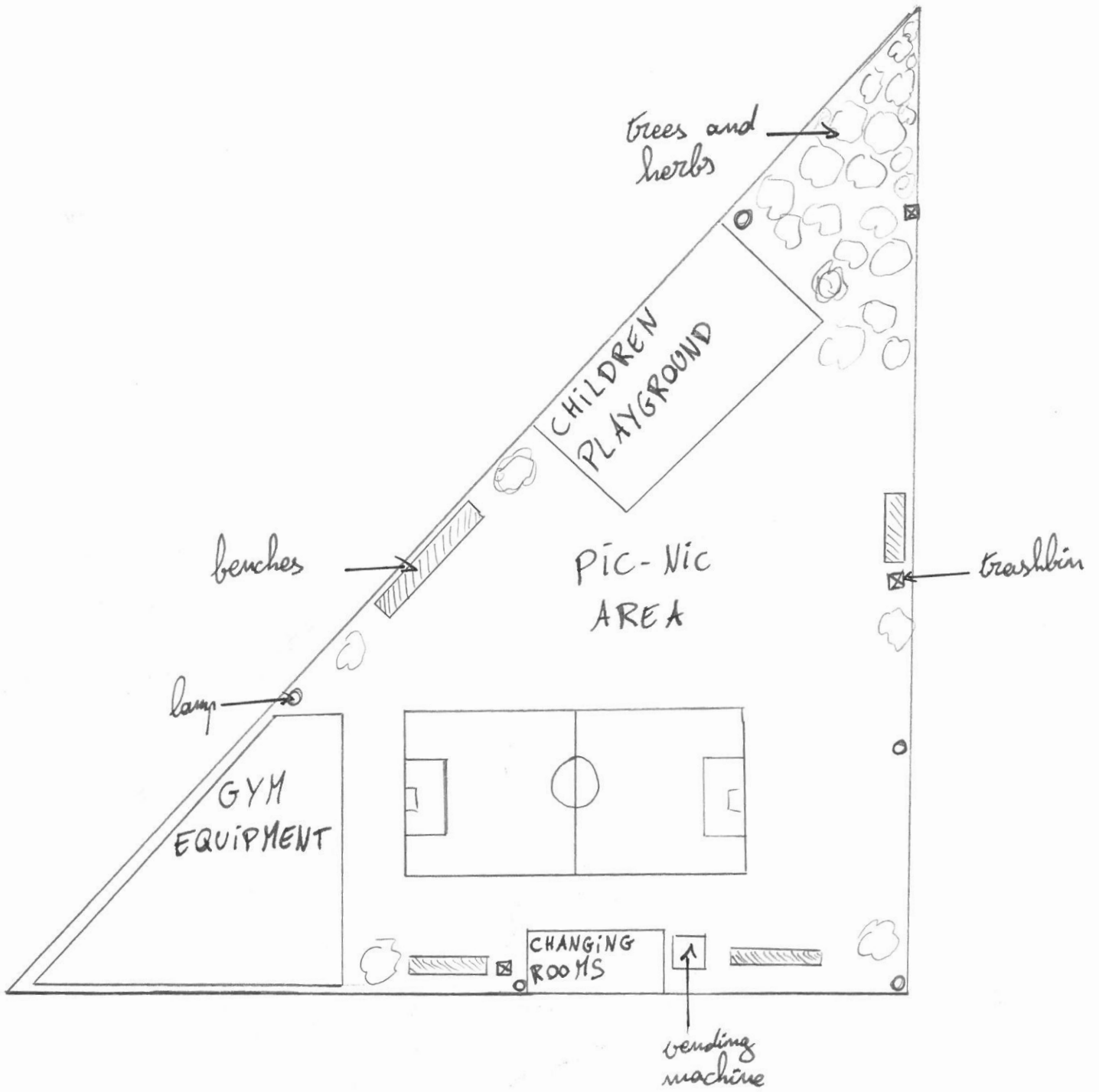

Dear Sir / Madam

My name's [redacted] a student at Newbury Hall. As I walked to the City Recreation Ground this morning, it impressed me as a great place to see.

City Park is a lovely park but in my opinion there should be some changes to make it more attractive. As I am a teenager, I think that it would be more attractive if there's a cafeteria. Of course after take some times in the park, we probably need some drinks and snacks. That's a great asset to have it and relax on benches to enjoy the sunshine. Moreover, there should be some trees such as Amelanchier, Malus Rudolph or Hibiscus Resi at the edge of the park. It can be mixed with some types of flowers like Lily, Tulip, Anemen or Carnation which has a great smell and beautiful shapes. I believe that adding a gym is a great idea to convince more people doing some sport and especially it's going to be useful for the citizens to be healthier and enjoyed this small town all year round.

I look forward to hearing from you soon.

Yours faithfully.

Dear Sir/Madam

I am a student at Newbury Hall School. I am writing to submit some ideas about how to enhance the city park from Newbury Hall School. I think that pathways should be made wider to prevent erosion from

pedestrians. Furthermore the pathways should be fixed because there are quite a few holes in it.

Also the bins are a issue, we often smell the rubbish that people leave on and also the dog bins that needs to be regularly cleaned.

As a ~~evening~~ ~~school~~ ~~doesn't~~ ~~really~~ ~~see~~ ~~the~~ ~~dogs~~ ~~-~~ ~~poop~~ ~~take~~ ~~more~~ ~~responsibility~~ ~~for~~ ~~what~~ ~~their~~ ~~dogs~~ ~~are~~ ~~doing~~ ~~in~~ ~~the~~ ~~park~~. Perhaps we could have more dog bins with an sign "please pick up, after your dog!". If it is possible to have a small cafe or to be more specific a kiosk, it would be unbelievable for us because it will be more comfortable for visitors to relax and to enjoy the nature from Newbury around them.

The park should also be more cleaner, the rubbish should be picked up by those who took it into the park. We also wish to have more trees and flowers to make the park look productive and colorful, we also could make tourists enjoyable to visit us.

The park should become a better place.

Yours faithfully

Newbury Hall School
Enborne road
Newbury
Berkshire
RG14 6AD

Newbury town Council
The Town Hall
Market Place
Newbury
Berkshire
RG14 5AA

Monday 25th February 2019

Dear Sir or Madam

I am a student at Newbury Hall School. I have walked in the park many times with my classmates. I heard about your plans to develop the park and I would like to make some suggestions.

Firstly I think you should put in a tennis court. Also I agree that a cricket pitch should be created.

Lastly I think there should be more things for children to play on. For example swings and slides.

Thank you
for your
attention

Newbury Town Council
The Town Hall
Market place
Newbury
Berkshire
RG14 5AA

25th February 2019

Dear Sir, Madam ;

I am writing this letter to share you my ideas concerning enhancements of the City Recreation Ground.

Firstly, I would like an enclosure with grass, sand and trees for the dogs. Indeed, the dog walkers will can run their dogs and the dogs will enjoy and do their "needs".

Secondly, I think you could build an area with slides, rounds about, swings, a climbing wall and sand and little grounds which would be good, recreational and playful for the toddlers and young children.

Also, for older children and teenagers, I propose that you install tennis courts, basketball hoops, soccer cages and a running track.

Lastly, for the elderly you need to install benches and make the paths safer.

I hope this is useful.

Yours faithfully,

Newbury Hall School
Enborne Road
Newbury
Berkshire
RG 14 6AD
25th February 2013

Sir/Madam
Newbury Town Council
The Town Hall
Market Place
Newbury
Berkshire
RG 14 5AA

Dear Sir/Madam,

I would like to give my decisions for the enhancement of the recreation ground.

Firstly, we can install different things like a Basketball hoop, football fields and tennis courts.

Secondly, we can put a walk way and the big field for the dogs that want to play.

In addition the city recreation ground can be better if there are games for toddlers and young children.

For example; swings, slides or climbing frames.

Then, I think we should implement more vegetation for example more trees and flowers to have better views so that the walks are more pleasant. I hope this is useful.

Yours sincerely

Newbury Hall School
Enborne Road Newbury
Berkshire RG14 6AD

25th Feb 2019

Newbury Town Council
The town Hall
market place
Newbury Berkshire RG14 5AA

Dear Sir/Madam

I am writing about my ideas to enhance the city recreation ground. First, you could instal basketball hoops because basketball is a great sport. You could also instal tennis courts for all people and for free of course!

Secondly, I welcome a junior cricket pitch on the ground as well because everyone encourage and support the teams of their choice.

In addition, you could plant more fruit-trees (apple trees, plum-trees and cherry trees) and plant more flowers. In summer, it was very beautiful with fruit and flowers with a lot of colours!

However, I very much disagree with opening the park to dogs. Dogs are very disgusting with badsmells. It is very dirty for the park.

lastly, you could build a terrace where adults can relax and also constructions adapted for adults or adolescents like big swings, slides or others...

Actually we have many ideas so, thank you.

Yours Sincerely

Dear Sir ~~Dear Sir~~

Newbury Rd 1 Sch

Enborne Road

Berkshire

RG4 5AD

~~Newbury~~ Date: Monday 25 Feb 2014

When I was looking over at Newbury Park I noticed how much free space there is and how many things. For example there is only one missing childrens area, and a big pitch, litter bins for dogs and 3 for people which is not enough. So you need to also there needs to be more lights around the park.

Thank you for attention
Yours

Newbury Town Council**Public Report****Community Services Committee, 11 March 2019****Agenda Item No 12****Dickens Walk Play Equipment**

To consider a recommendation to allocate £2,300 funding from S106 monies to allow the replacement of play equipment at Dickens Walk Playground

Background:

The Council has provided 9 pieces of playground equipment at Dickens Walk. The playground is in a high-density residential area and is very well used by the local community. As a result, with wear & tear, there are three damaged items of play equipment at Dickens Walk.

We intend to replace these with 2 new play units, a new roundabout and seesaw, see pictorial.

The total cost of the replacement is £8,221.

A sum of £5,921 will be funded by the Playground Equipment R & M budget of 2018/19.

The balance of £2,300 is required from S106 monies.

The recommended quote from supplier of the new equipment is appended for the information of Members

Objective

To ensure the playground at Dickens Walk is safe and fun to use for local residents.

Options

1. Do nothing- not an option
2. Remove equipment and do not replace
3. Allocated the funding so that the equipment can be replaced.

Financial and Legal Implications

The total cost of the replacement is £8,221.

A sum of £5,921 will be funded by the Playground Equipment R & M budget of 2018/19.

The balance of £2,300 is required from S106 monies.

Reference to Council Strategy, where relevant

The Council Strategy includes the following objectives:

01.6 - Maintain and run high quality parks, playground and leisure spaces/facilities

Recommendation(s)

Officers recommend that £2,300 is allocated from S106 monies to allow the works to go ahead at Dickens Walk.

Signed: David Ingram
Community Services Manager

5 March 2019

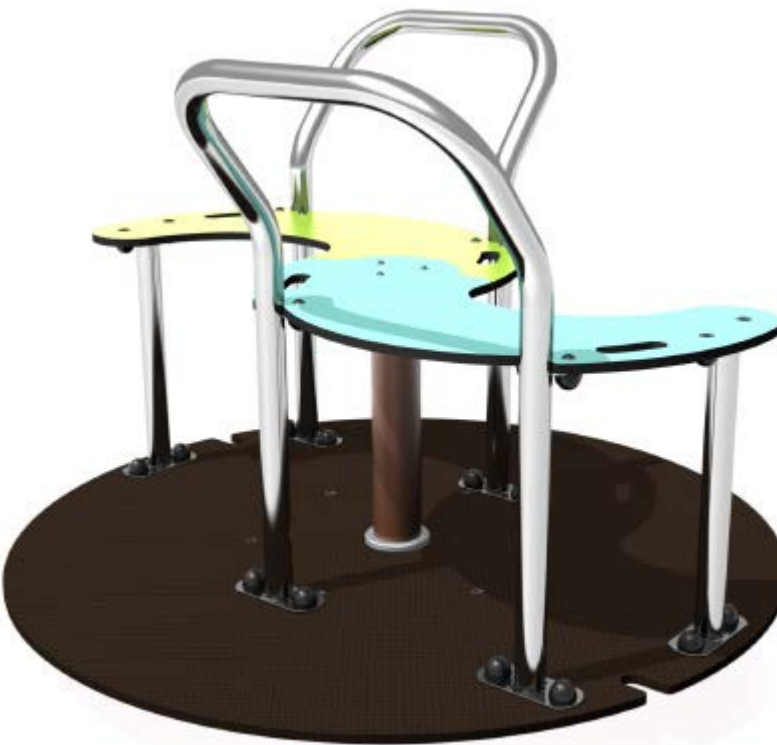



James Heasman
 Newbury Town Council
 1 Old Town Hall
 Market Place
 Newbury
 Berkshire
 RG14 5AA

26 November 2018

Dear James,

Thank you for allowing us the opportunity to quote for Dickens Walk Play Area , Newbury.

Our aim at Proludic is to capture the imagination of every visitor to our play areas through inventive designs, creative ideas on inclusive play and stimulating products. We design our play areas to incorporate all these aspects whilst ensuring we achieve compliance with the relevant legislations.

We offer a full service including advice, design, contract management and a dedicated after sales service which is unmatched in this industry. We pride ourselves on our offering of complete solution from start to finish of your project.

We will contact you within two weeks to see how we can help further with your project. However if you have any queries regarding this quote or any part of our service in the meantime please do not hesitate to contact me on .

Yours sincerely

Danny Smith
 Area Manager
 Proludic Ltd

Prepared for: Newbury Town Council
 Our Reference: 1811.20907
 Date: 26 November 2018

Quotation for Dickens Walk Play Area , Newbury

Qty	Code	Product Name	Unit Price	Total	Line Price
-----	------	--------------	------------	-------	------------

01. Proludic Play

1		J830A Quatro Springer	2,100	2,100	
1		PJ830A Installation of J830A	200	200	

1		J2404A Low Platform Roundabout 2,050 2,050	
1		PJ2404A Installation of J2404A	392 392
		Total:	£4,742

09. Safer Surfacing

36	UKS1016	EnviroSMART Grass mat 3m CFH (per m ²)	28 1,008
		Total:	£1,008

10. Groundwork and Landscaping

20	UKPQ1020	Topsoil & Turf m ²	18 360
1	UKPV1013	Dig and dispose of 1x roundabout, 1x springer ground fixings & 12m ² grassmat	700 700
		Total:	£1,060

11. Miscellaneous Items

1	UKA1100	Post Installation Inspection	450 450
1	UKA1001	Prelims (Under 10K)	650 650
		Total:	£1,100

Delivery Charge: £311

Total Quote Amount: £8,221

Based on a flat fully established grass site.

Proposed Grassmat Safer surfacing is based on a fully established grass site (including a minimum of 150mm of good quality soil and turf).

Preliminaries have been included within your quotation, these equate to site setup, site storage, delivery, unloading of equipment, site welfare, heras fencing & signage and skips (this can also include supervision where necessary).

Topsoil & Turf watering to be done by others and has not been costed for.

Some images shown are for illustrative purposes only. The quote and items list will show the exact equipment used.

This quote is valid until 31/12/2018
Please note all prices quoted are excluding VAT

Terms and Conditions

Formation of a Contract

The quotation given on or attached to these terms and conditions will remain valid for a period of 90 days, unless otherwise stated on the quote. Acknowledgment and acceptance of this proposal is made by you placing an order within the specified period above, at which time you will be bound by these terms and conditions. Each proposal accepted shall constitute an individual legally binding contract between you and us. Such contract is hereinafter referred to in these terms and conditions as "an order".
Nothing in these terms and conditions shall prejudice any condition or warranty expressed or implied, or any legal remedy to which we may be entitled in relation to the goods / and or the work the subject of this order.

Newbury Town Council

Public Report

Community Services Committee, 11 March 2019

Agenda Item No 13

Town Hall defibrillator

To consider the installation of a defibrillator in Newbury Town Hall

Background:

As part of Newbury Town Council's Strategy to further enhance service & experience for its residents by installing a lifesaving defibrillator in Newbury Town Hall for use in the Central Market Place area of Newbury.

The British Heart Foundation suggests:

To help someone who is in cardiac arrest effectively, a defibrillator needs to be found as quickly as possible. For every minute it takes for the defibrillator to reach someone and deliver a shock, their chances of survival reduce by up to 10%.

The Resuscitation Council (UK) state:

Only 3% of cardiac arrests happen within the recommended retrieval distance of a defibrillator.

Objective

To examine cost of installing **a defibrillator** in the Town Hall with the options to purchase or lease, including associated management costs.

Options

1. Do nothing
2. Purchase & install a defibrillator
3. Lease a defibrillator managed by a third party

Financial and Legal Implications

The costs relating to the **defibrillator** are:

- Purchase with 5 year management costs
- Lease with 5 year management costs

Purchase :

The St John Ambulance recommended, **Zoll AED Plus fully automatic defibrillator**, purchase cost £1,056 with a need to replace the battery every 4 years at £270 and replacement pads, as and when needed cost £45. Total cost assuming 5 years life, annual replacement of pads and one new battery pack, £1,551 plus Vat.

Rental

Defribmachines Ltd, one of the UKs leading rental Companies for defribulator, have quoted an annual cost of £365 plus Vat to provide, install and manage a defribulator in Newbury Town Hall on a fixed 5 year Contract, total cost £1,825 plus Vat.

Issues to be considered before entering into a Rental include:

Is the rental price guaranteed for the life of the rental?

What is the service level agreement? (i.e. Service and fixing turnaround time)

How would faults in the system be dealt with?

Do new pads and batteries need to be ordered or are they 'auto' sent? (Like you can get with printer ink for example)

What are the cancellation clauses?

When the defibrillator is returned at the end of the rental agreement how quickly will the deposit be returned and what level of wear & tear would be considered acceptable?

If these defibrillator are identified during the life of the contract to be 'unsafe' would they be replaced for free?

Reference to Council Strategy, where relevant

The Town Council is committed to continuing to make Newbury a better place to live, work and visit. The Council Strategy includes the following objectives:

O2.MTP9 Support initiatives to make Newbury a more inclusive town

Recommendation(s)

To resolve to provide a Defibrillator in the Town Hall subject to obtaining best rental value in the market on a rental basis for a period of no more than 5 years.

Signed: David Ingram
Community Services Manager

5 March 2019

Newbury Town Council**Public Report****Community Services Committee, 11 March 2019****Agenda Item No 14****Victoria Park Ice Rink Proposal****To consider** the viability of an ice-rink at the pond in Victoria Park.**Background:**

As part of Newbury Town Council's Strategy to further enhance and improve the services we deliver, we have assessed the viability of an ice-rink in the pond in Victoria Park.

Objective

To receive quotes and information on how a facility such as this could be run and the costs involved.

Options

1. Do nothing
2. Install temporary rink each year
3. Install permanent fixtures and fittings in the pond to enable annual installation

Financial and Legal Implications

The costs relating to the Ice Rink are:

1. Temporary rink each year – £180,000 plus running costs suggested by Christmas Icerinks, Swindon which could amount to over £240,000 in a season.
The suggestion is a footfall of circa 30,000 would be required over the Xmas period to maximise any return on investment to cover running costs, setup and dismantling. It is usually sink costs by the Client.
2. Permanent fixtures and fittings – at an approximate cost of £995,925 (see attached quotation from Adminex Technologies Ltd) as an indication of outlay for a permanent installation

Reference to Council Strategy, where relevant

The Council Strategy includes the following objectives:

- 01.6 - Maintain and run high quality parks, playground and leisure spaces/facilities
- O1.MTP7 - Maintain Victoria Park as a first class amenity and recreational area for the benefit of all the citizens of Newbury and achieve the Green Flag Award for Victoria Park
- O1.STP5 – Assess the viability of an ice-rink at the pond in Victoria Park

Recommendation(s)

Officers be instructed not to pursue this opportunity of the installation of an Ice Rink in Victoria Park due to the significant investment needed, showing an uncertain return on the suggested investment.

Signed: David Ingram
Community Services Manager

5 March 2019

NEWBURY - PROVISIONAL FEASIBILITY STUDY SUMMARY
ATL/PDB 24.01.2019

36m x 36m ICE RINK FOR PUBLIC RECREATIONAL SKATING

1. TOTAL PROJECT COST

	£
COMPLETE ICE RINK PROJECT COMPRISING -	
A. BUILDING WORKS	
SITE SURVEY AND STRUCTURAL DESIGN	7,425
SITE MOBILISATION, SITE OFFICE, DRYING ROOM, MEETING AND CANTEEN ROOM, TOILETS)	
STORAGE CONTAINER, TEMPORARY WORKS AND INSURANCE,)	17,900
HEALTH & SAFETY INCL DOCUMENTATION, SITE INSPECTIONS, TEMPORARY BARRIERS	
FENCING AND LIGHTING	19,500
BUILDING WORKS INCL REVERSE/RETURN HEADER AND TRANSMISSIN TRENCHES, FOR PIPE GRID)	
TRENCHES FOR DRAINAGE AND UTILITIES, REINFORCED SLAB FOR RINK, HARD STANDING FOR CHILLER)	
PUMPS AND ICE PIT BOILER, ICE PIT, BASE PAINT AND PAINTING, RAMP FOR RE-SURFACER)	
HANDLING EQUIPMENT, SITE MANAGER AND SITE ENGINEER)	241,900
B. EQUIPMENT	
ICE RINK DESIGN AND PROJECT MANAGEMENT	44,500
HIGH DENSITY POLYETHYLENE FUSION REFRIGERATION PIPE GRID INCLUDING MATERIALS, ON-SITE LABOUR AN)	
INCLUDING ON-SITE INSTALLATION LABOUR AND SECONDARY REFRIGERANT)	179,800
ALUMINIUM FRAMED PERIMETER BOARDS WITH HIGH DENSITY POLYETHYLENE FACING, KICK BOARDS,)	
CAP RAILS, INCLUDING RESURFACER GATE AND SKATER GATES)	
INCLUDES LABOUR FOR INSTALLATION)	151,900
SUB-TOTAL as per our email budget 31.10.18	662,925
OTHER ASSETS -	
CHILLER, PUMPS & SKIDS, PRIMARY REFRIGERANT (could be hired)	150,000
ICE MAKING TOOLS and initial ice making	40,000
RE-SURFACER (could be hired)	60,000
INITIAL SUPPLY OF 700 PAIRS ICE SKATES	28,000
ICE SKATE LOCKERS	10,000
MAINTENANCE EQUIPMENT	5,000
CONTINGENCY	30,000
TOTAL BUILDING & EQUIPMENT COST (incl items that could be optionally hired as above)	985,925
WORKING CAPITAL	10,000
TOTAL PROJECT COST	995,925

2. PROJECTED FINANCIAL STATEMENTS

OPERATING STATEMENT - ESTIMATED

SALES REVENUE	364,000
OPERATING EXPENSES	112,400
PROFIT BEFORE TAX	251,600

SALES REVENUE

Public Skating

8 sessions per day for 91 days for 50 skaters each session @ £10.00 per session plus VAT 364,000

OPERATING COSTS - DETAILED CALCULATIONS

Staff costs

2 full-time and 4 part time staff = 4 full-time staff @ £4000 plus 15% benefits 18,400

Electricity

30,000

Water

2,000

Maintenance & Spares

500

Skate Replacements

200 pairs ice skates at £30 each each year 6,000

Insurance

3,000

Marketing & Promotion

5,000

Computer expenses

500

Printing, Postage & Stationery

500

Audit & Accountancy

1,000

Bank Charges

500

Contingency

15,000

Annual Dismantling, re-assembly, storage and ice making

30,000

TOTAL

112,400

Newbury Town Council

Work Programme for Community Services Meetings for the Municipal Year 2018/19

Meeting Date	Item
24 September 2018	To receive a presentation on “Building Communities Together” by the WBDC team manager, Susan Powell- deferred to December
	Allotment Awards - make presentations to the winning Tenants and Allotment Site
	To consider street lighting revised costs attributed to a street lighting proposal along the pathway between Park Way and St Marys Road entrances to Victoria (see CSM report)
	Review of Grounds Maintenance performance (see CSM report)
	Tree Planting Programme (Town Design Statement)
	Approve arrangements for VP Café and Changing rooms
	Approve an action plan to further raise the profile and improve the appearance of the Council's markets, taking into account the changing shopping patterns and requirements of the people of Newbury- defer to December
10 December 2018	To receive a presentation on “Building Communities Together” by the WBDC team manager, Susan Powell
	Review and consider any additions, amendments or deletions to the detailed Service Plans before they are published as a new starting point on the Town Council website.
	Approve an action plan to further raise the profile and improve the appearance of the Council's markets, taking into account the changing shopping patterns and requirements of the people of Newbury
	Consider proposals for Service Revenues for 2019/20 and allotment for 2021/22
	Consider Officers' proposal for the Community Services Budget for the 2018/19 financial year, and in particular to consider any additions, amendments or deletions required, before inclusion in draft budget for Policy & Resources Committee consideration on 14 January 2019
	Land at Fifth Road
11 March	Consider options and dates for Victoria Park 2019 Family Day
	Update on Victoria Park café and changing rooms
	Investigate and assess the viability of an ice-rink at the pond in Victoria Park
	City Rec consultation
2019/20	
May/ June 2019	Nomination and Election of Community Services Chair and Vice-chair
	Agree membership of each Community Services Working Group for the 2019/2020 municipal year
	Update on Community café and Changing rooms for Victoria Park

Recommendation: To note and agree any other items that Members resolve to add to the Forward Work Programme